

RoHS

SPECIFICATIONS

Rated Current:1.5AMP
 Contact Resistance:20mΩ Max
 Withstand Voltage:400V AC/DC
 Insulation Resistance:800MΩ Min
 Operation Temperature: -40°c to +105°c

Contact Material:Brass
 Contact Plating:Au Over Ni
 Insulator Material:Polyester(UL94V-0)
 Standard: PA6T
 Max.Processing Temp: 230°C for 30-60 seconds
 (260°C for 10 seconds)

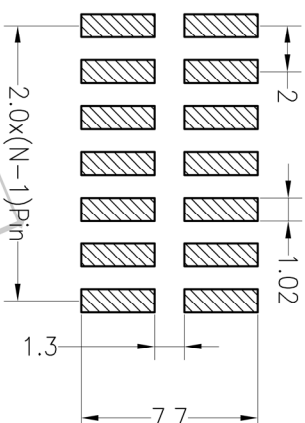
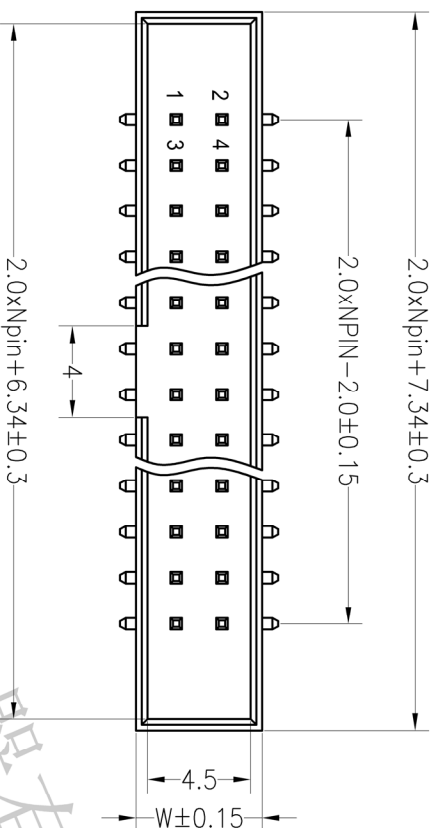

Recommended P.C.B Layout(Top Side)
 (PCB BOARD TOLERANCE±0.05)

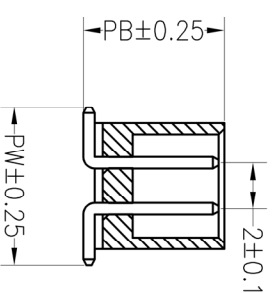
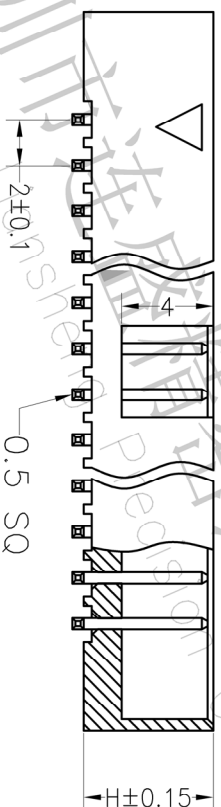

Ordering Information

J	X	XXX	X	XX	X	X	X	XXXX
产品类别 J=筒件	颜色 1=1.27 2=2.0 3=2.54 4=3.96 5=1.0 6=4.0 7=5.08 A=1.27*2.54	总长度 016=8P	产品形态 1=DIP 2=RA 3=SMT 4=SH 5=板贴脚	电镀厚度 00=指镀 01=10" 02=20" 03=30" S=镀锡	绝缘材料 1=PBT 2=LCP 3=PPS 4=PA66 5=PA6T 9=PA9T	镀层颜色 1=蓝色 2=灰色 3=白色 4=蓝色 5=红色 6=黄色 7=灰白色	包装方式 1=散装 2=卷装 3=袋装 4=袋装 5=盒装	序列号 0001-9999

Dimension antitheses list

ITEM	PB	PC	PW	H	W
001	6.3		6.9	5.65	5.5
002					

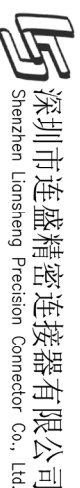

深圳市连盛精密连接器有限公司
 Shenzhen Lensheng Precision Connector Co., Ltd.

OPERATION

X.X ±0.30

X.XX ±0.20

X.XXX ±0.10

Angle ±3°

DIM TOL

DRAW

CHECK

APPROVE

SCALE

UNIT

SIZE

SHEET

PROJ.

SCALE

mm

A4

1/1

1/1

1/1

1/1

1/1

PART NO.

2.0Box

Npin

H5.65

SMT

TITLE:

2.0Box Npin H5.65 SMT

DATE

2012.03.28

NEW DRAWING

MODIFICATION DESCRIPTION

CHANGE

DIM

TOL

DATE

2012.03.28

NEW DRAWING

MODIFICATION DESCRIPTION

CHANGE

DIM

TOL