

ROHS

SPECIFICATIONS

Rated Current: 3.0AMP
 Contact Resistance: 20mΩ Max
 Withstand Voltage: 1000V AC/DC
 Insulation Resistance: 1000MΩ Min
 Operation Temperature: -40°C to +105°C

Contact Material: Brass
 Contact Plating: Au是0.5U Over Ni
 Insulator Material: Polyester(UL94V-0)
 Standard: PA6T
 Max.Processing Temp: 230°C for 30-60 seconds
 (260°C for 10 seconds)

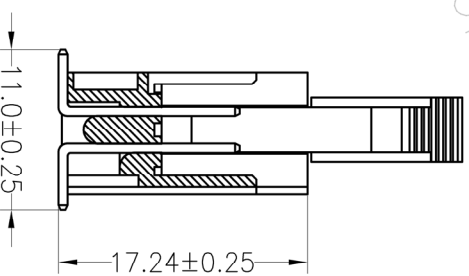
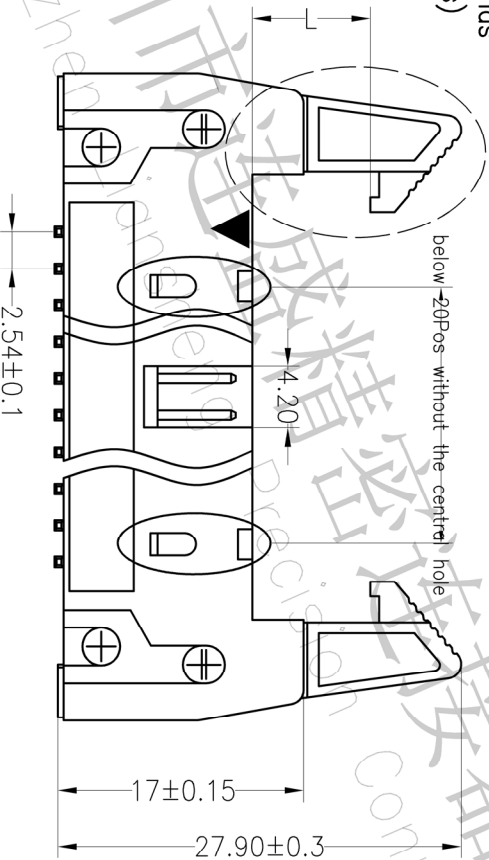
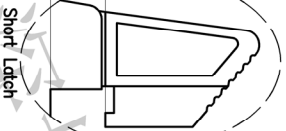
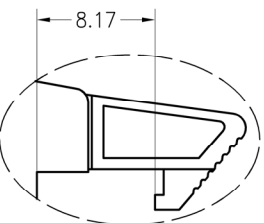
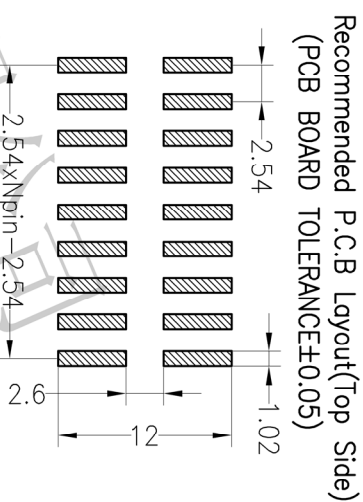
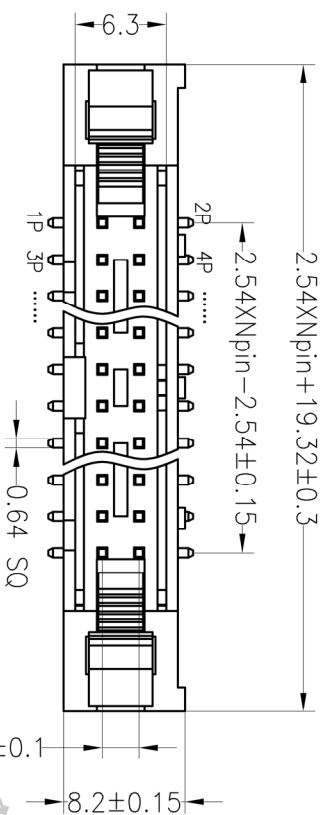

Ordering Information

N	X	XXX	X	XX	X	X	X	XXXX
产品类别	向角	边引数	产品形态	电镀厚度	绝缘材料	镀层颜色	特殊处理	序列号
N=1角	7	016=16P	3=SMT	0.0=0.0μm	1=PA6T	1=蓝色	1=标准	0000-9999
2=2角	3&2.54		4=SH	0.1=0.1μm	2=PA6	2=灰色	2=长耳	
4=3.6角			5=微脚	0.3=0.3μm	3=PA6S	3=黑色	3=短耳	
6=6角					4=PA6G	4=白色	4=平耳	
7=5.0角					5=PA6T	5=黄色		
A=1.27-2.54					9=PA6T	7=灰白色		

Dimension anttheses list

ITEM	PB	PC	PW	H	W
001					
002					

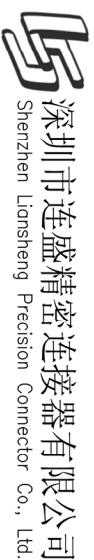

深圳市连盛精密连接器有限公司
 Shenzhen Liansheng Precision Connector Co., Ltd.

A

REV	DATE	MODIFICATION DESCRIPTION	CHANGE	OPERATION	DRAW	SCALE	FIT	PART NO.	TITLE:
A0	2012.03.28	NEW DRAWING		X.X ±0.30	CHECK	UNIT mm	A4	2.54EDH NP SMT=11.0 长耳扣	
1				X.XX ±0.20	APPROVE	SIZE A4	1/1		
				X.XXX ±0.10		SHEET			
				Angle ±3°		PROJ.			
				DIM					
				TOL					

B

ITEM	PB	PC	PW	H	W
001					
002					

C

Ordering Information

N	X	XXX	X	XX	X	X	X	XXXX
产品类别	向角	边引数	产品形态	电镀厚度	绝缘材料	镀层颜色	特殊处理	序列号
N=1角	7	016=16P	3=SMT	0.0=0.0μm	1=PA6T	1=蓝色	1=标准	0000-9999
2=2角	3&2.54		4=SH	0.1=0.1μm	2=PA6	2=灰色	2=长耳	
4=3.6角			5=微脚	0.3=0.3μm	3=PA6S	3=黑色	3=短耳	
6=6角					4=PA6G	4=白色	4=平耳	
7=5.0角					5=PA6T	5=黄色		
A=1.27-2.54					9=PA6T	7=灰白色		

D

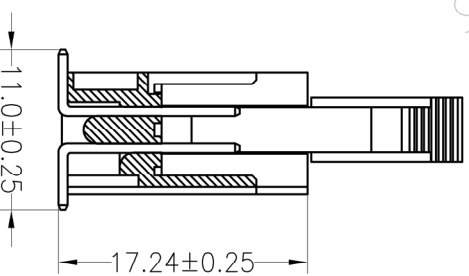
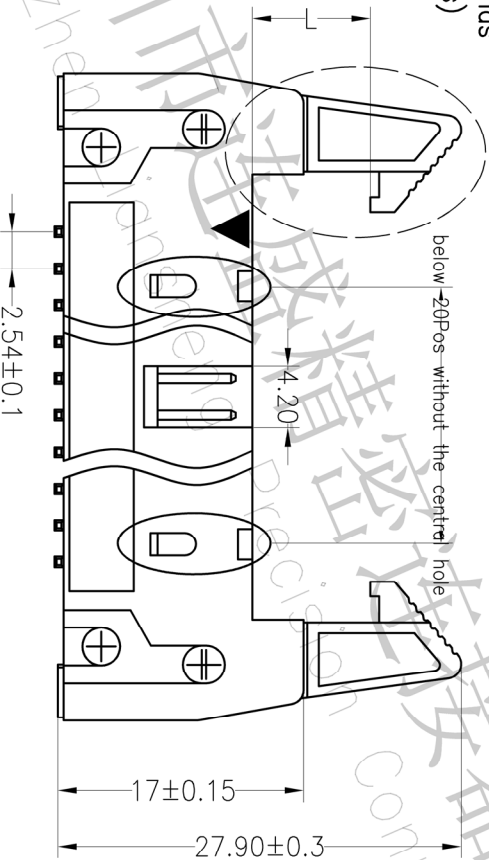
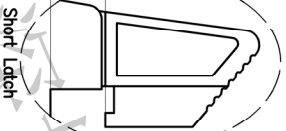
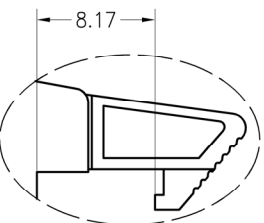

E

Contact Material: Brass
 Contact Plating: Au是0.5U Over Ni
 Insulator Material: Polyester(UL94V-0)
 Standard: PA6T
 Max.Processing Temp: 230°C for 30-60 seconds
 (260°C for 10 seconds)

F

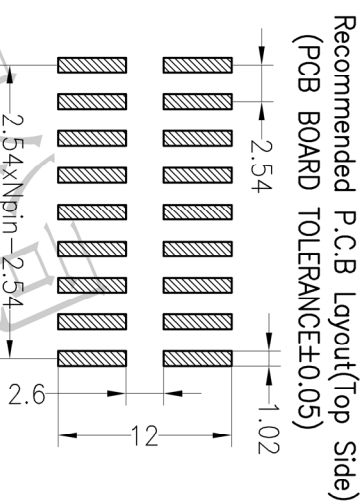
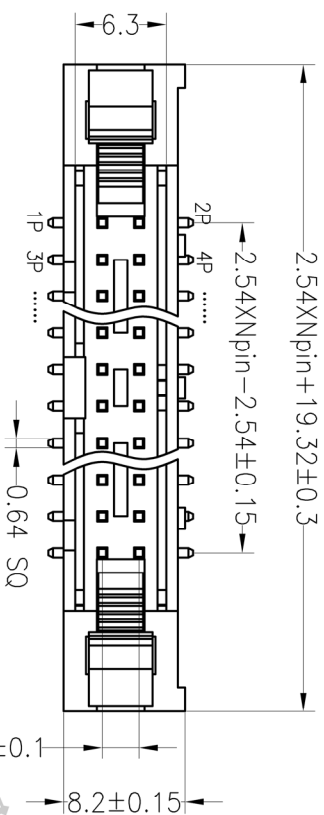

G

ROHS

SPECIFICATIONS

Rated Current: 3.0AMP
 Contact Resistance: 20mΩ Max
 Withstand Voltage: 1000V AC/DC
 Insulation Resistance: 1000MΩ Min
 Operation Temperature: -40°C to +105°C

Contact Material: Brass
 Contact Plating: Au是0.5U Over Ni
 Insulator Material: Polyester(UL94V-0)
 Standard: PA6T
 Max.Processing Temp: 230°C for 30-60 seconds
 (260°C for 10 seconds)

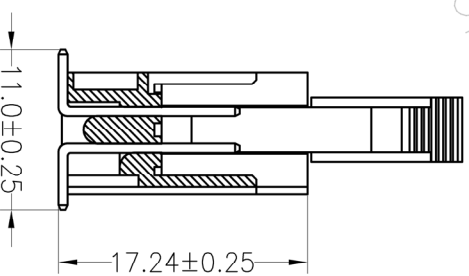
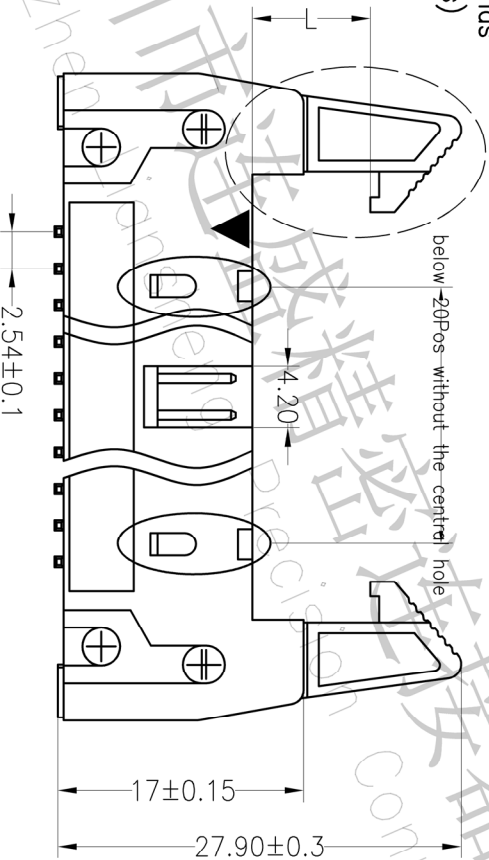
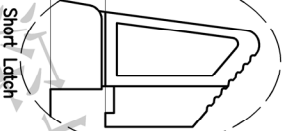
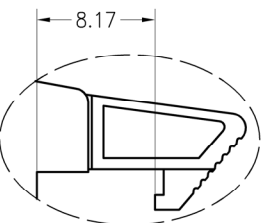
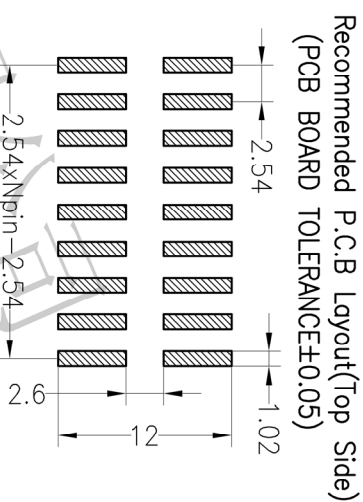
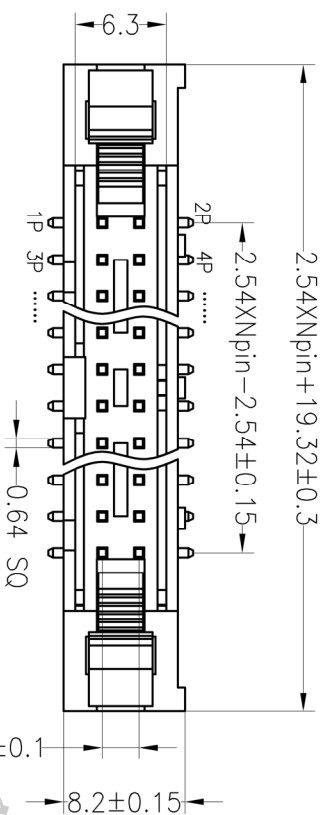

Ordering Information

N	X	XXX	X	XX	X	X	X	XXXX
产品类别	向角	边引数	产品形态	电镀厚度	绝缘材料	镀层颜色	特殊处理	序列号
N=1角	7	016=16P	3=SMT	0.0=0.0μm	1=PA6T	1=蓝色	1=标准	0000-9999
2=2角	3&2.54		4=SH	0.1=0.1μm	2=PA6	2=灰色	2=长耳	
4=3.6角			5=微脚	0.3=0.3μm	3=PA6S	3=黑色	3=短耳	
6=6角					4=PA6G	4=白色	4=平耳	
7=5.0角					5=PA6T	5=黄色		
A=1.27-2.54					9=PA6T	7=灰白色		

Dimension anttheses list

ITEM	PB	PC	PW	H	W
001					
002					

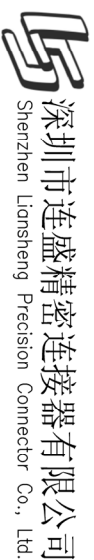

深圳市连盛精密连接器有限公司
 Shenzhen Liansheng Precision Connector Co., Ltd.

A

REV	DATE	MODIFICATION DESCRIPTION	CHANGE	OPERATION	DRAW	SCALE	FIT	PART NO.	TITLE:
A0	2012.03.28	NEW DRAWING		X.X ±0.30	CHECK	UNIT mm	A4	2.54EDH NP SMT=11.0 长耳扣	
1				X.XX ±0.20	APPROVE	SIZE A4	1/1		
				X.XXX ±0.10		SHEET			
				Angle ±3°		PROJ.			
				DIM					
				TOL					

B

ITEM	PB	PC	PW	H	W
001					
002					

C

Ordering Information

N	X	XXX	X	XX	X	X	X	XXXX
产品类别	向角	边引数	产品形态	电镀厚度	绝缘材料	镀层颜色	特殊处理	序列号
N=1角	7	016=16P	3=SMT	0.0=0.0μm	1=PA6T	1=蓝色	1=标准	0000-9999
2=2角	3&2.54		4=SH	0.1=0.1μm	2=PA6	2=灰色	2=长耳	
4=3.6角			5=微脚	0.3=0.3μm	3=PA6S	3=黑色	3=短耳	
6=6角					4=PA6G	4=白色	4=平耳	
7=5.0角					5=PA6T	5=黄色		
A=1.27-2.54					9=PA6T	7=灰白色		

D

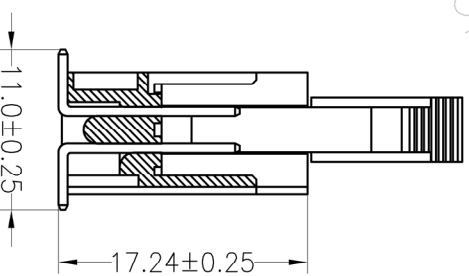
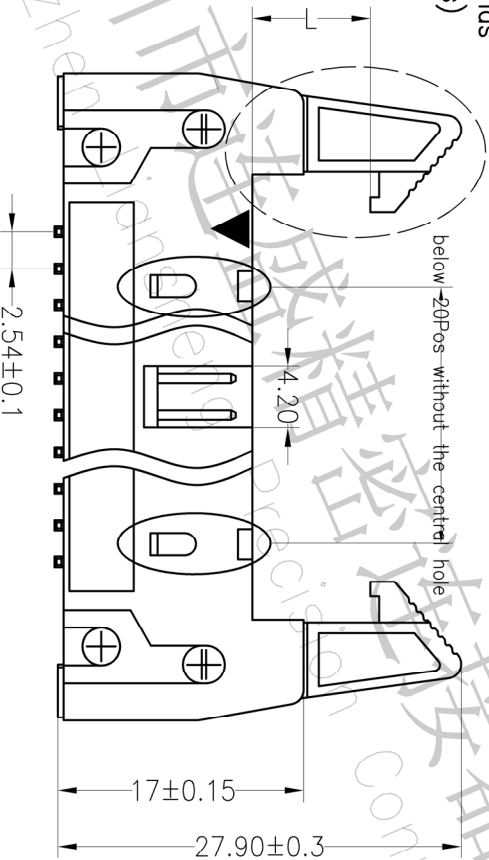
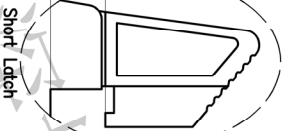
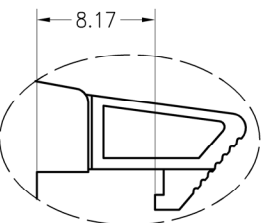

E

Contact Material: Brass
 Contact Plating: Au是0.5U Over Ni
 Insulator Material: Polyester(UL94V-0)
 Standard: PA6T
 Max.Processing Temp: 230°C for 30-60 seconds
 (260°C for 10 seconds)

F

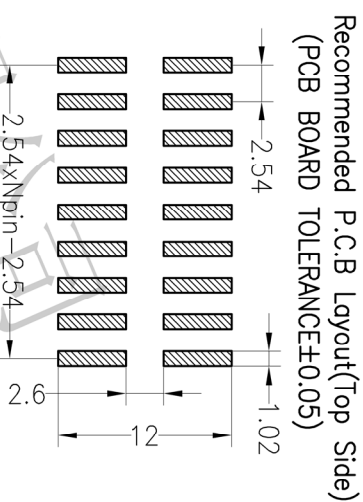
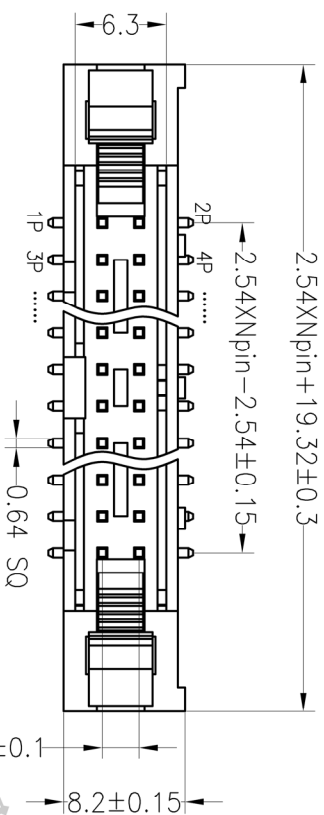

G

ROHS

SPECIFICATIONS

Rated Current: 3.0AMP
 Contact Resistance: 20mΩ Max
 Withstand Voltage: 1000V AC/DC
 Insulation Resistance: 1000MΩ Min
 Operation Temperature: -40°C to +105°C

Contact Material: Brass
 Contact Plating: Au是0.5U Over Ni
 Insulator Material: Polyester(UL94V-0)
 Standard: PA6T
 Max.Processing Temp: 230°C for 30-60 seconds
 (260°C for 10 seconds)

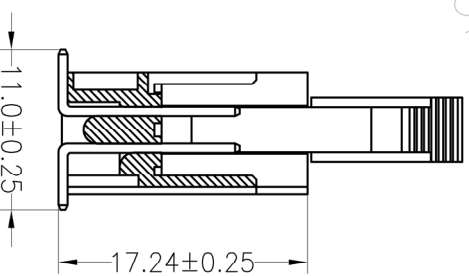
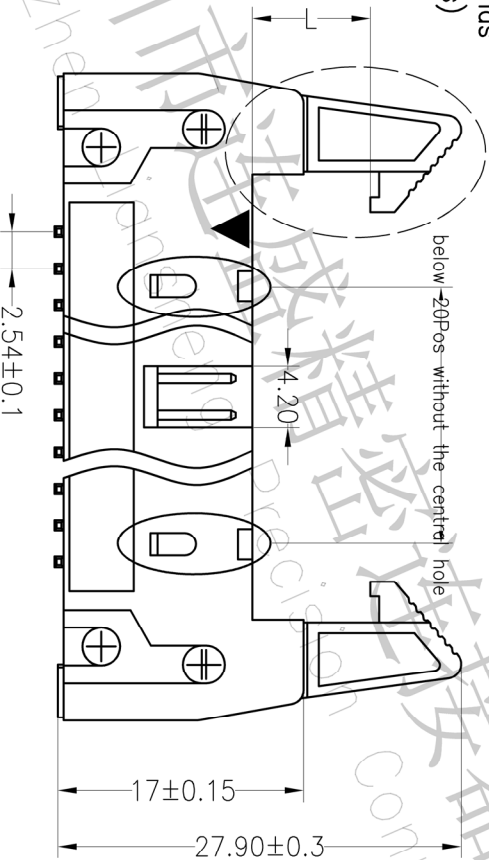
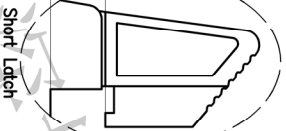
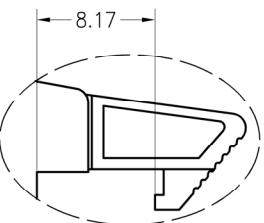
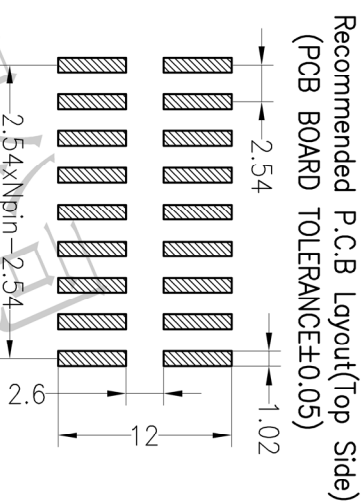
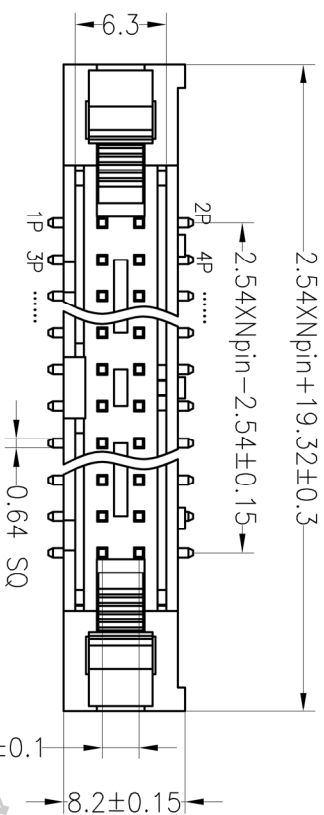

Ordering Information

N	X	XXX	X	XX	X	X	X	XXXX
产品类别	向角	边引数	产品形态	电镀厚度	绝缘材料	镀层颜色	特殊处理	序列号
N=1角	7	016=16P	3=SMT	0.0=0.0μm	1=PA6T	1=蓝色	1=标准	0000-9999
2=2角	3&2.54		4=SH	0.1=0.1μm	2=PA6	2=灰色	2=长耳	
4=3.6角			5=微脚	0.3=0.3μm	3=PA6S	3=黑色	3=短耳	
6=6角					4=PA6G	4=白色	4=平耳	
7=5.0角					5=PA6T	5=黄色		
A=1.27-2.54					9=PA6T	7=灰白色		

Dimension anttheses list

ITEM	PB	PC	PW	H	W
001					
002					

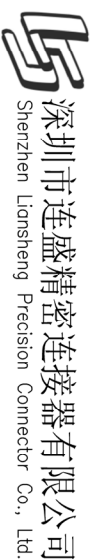

深圳市连盛精密连接器有限公司
 Shenzhen Liansheng Precision Connector Co., Ltd.

A

REV	DATE	MODIFICATION DESCRIPTION	CHANGE	OPERATION	DRAW	SCALE	FIT	PART NO.	TITLE:
A0	2012.03.28	NEW DRAWING		X.X ±0.30	CHECK	UNIT mm	A4	2.54EDH NP SMT=11.0 长耳扣	
1				X.XX ±0.20	APPROVE	SIZE A4	1/1		
				X.XXX ±0.10		SHEET			
				Angle ±3°		PROJ.			
				DIM					
				TOL					

B

ITEM	PB	PC	PW	H	W
001					
002					

C

Ordering Information

N	X	XXX	X	XX	X	X	X	XXXX
产品类别	向角	边引数	产品形态	电镀厚度	绝缘材料	镀层颜色	特殊处理	序列号
N=1角	7	016=16P	3=SMT	0.0=0.0μm	1=PA6T	1=蓝色	1=标准	0000-9999
2=2角	3&2.54		4=SH	0.1=0.1μm	2=PA6	2=灰色	2=长耳	
4=3.6角			5=微脚	0.3=0.3μm	3=PA6S	3=黑色	3=短耳	
6=6角					4=PA6G	4=白色	4=平耳	
7=5.0角					5=PA6T	5=黄色		
A=1.27-2.54					9=PA6T	7=灰白色		

D

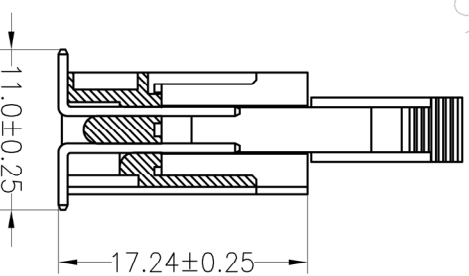
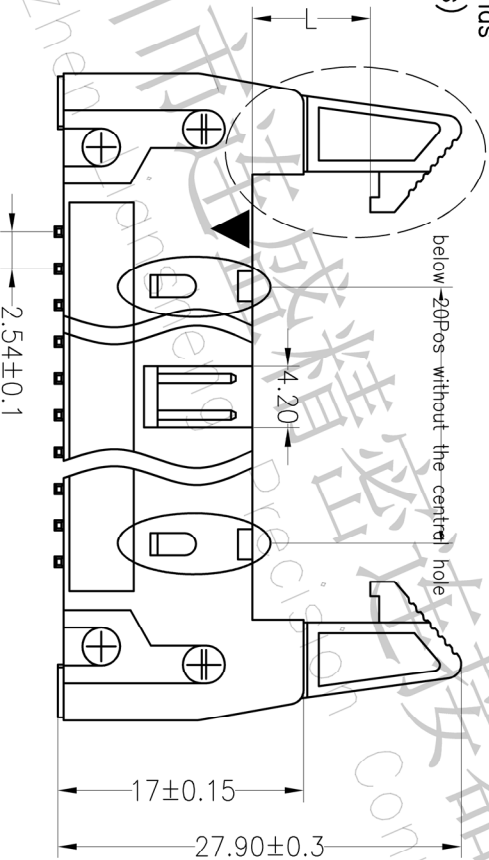
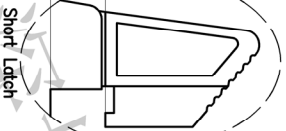
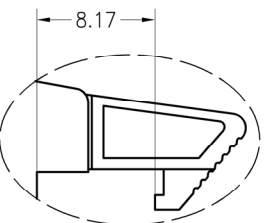

E

Contact Material: Brass
 Contact Plating: Au是0.5U Over Ni
 Insulator Material: Polyester(UL94V-0)
 Standard: PA6T
 Max.Processing Temp: 230°C for 30-60 seconds
 (260°C for 10 seconds)

F

