

RoHS

SPECIFICATIONS

Rated Current:1.0AMP
 Contact Resistance:20mΩ Max
 Withstand Voltage:500V AC/DC
 Insulation Resistance:1000MΩ Min
 Operation Temperature:−40°C to +105°C

Contact Material:Phosphor Bronze

Contact Plating:Au Over Ni

Insulator Material:Polyester(UL94V-0)

Standard: PA6T

Max.Processing Temp: 230°C for 30–60 seconds
 (260°C for 10 seconds)

Ordering Information

F	X	A	X	XX	X	S	X	XX	X	XXXX
产品类别 F=排母	间距 2=2.54 3=2.54 4=3.96 5=1.0 6=0.8 7=0.8 A=1.27/2.54	接触高度 A=2.0	排数 1=单排 2=双排 3=三排 4=四排	接触形式 1~4P	产品形状 2=PM 3=SWT 4=SH 5=线贴脚 6=侧插SMT 7=侧插SMT	塑胶材料 1=PA6 2=PA66 3=PA6T 4=PA6T 5=PA6T 9=PA6T	电镀厚度 00=高度 01=10° 02=20° 03=30° 04=45° 05=60° 06=75° 07=90° 08=105° 09=120° 10=135° 11=150° 12=165° 13=180° 14=195° 15=210° 16=225° 17=240° 18=255° 19=270° 20=285° 21=300° 22=315° 23=330° 24=345° 25=360°	包装方式 1=散装 2=卷装 3=盘装 4=袋装 5=盘装	序列号	

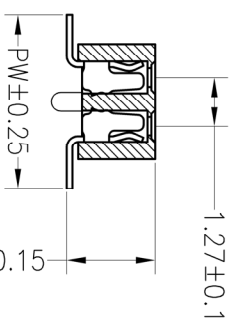
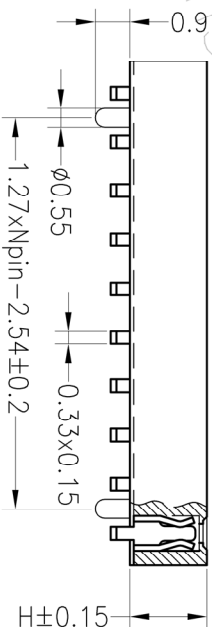

Dimension antitheses list						
ITEM	PB	PC	PW	H	W	L
001	2.30		4.50	2.0	3.0	
002						

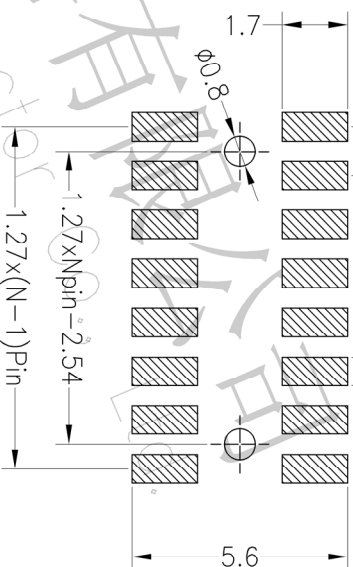
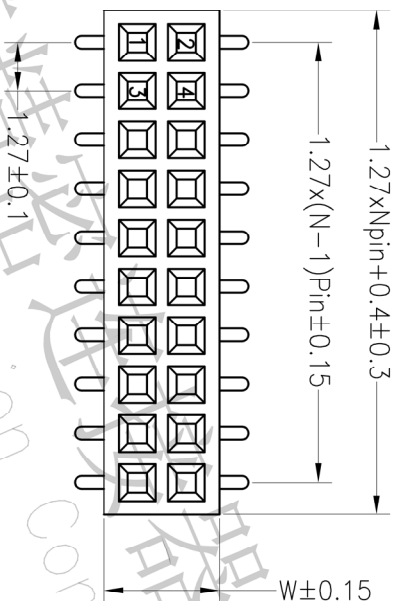

Recommended P.C.B Layout(Top Side)
 (PCB BOARD TOLERANCE±0.05)

OPERATION

X.X ±0.30

X.XX ±0.20

X.XXX ±0.10

Angle ±3°

DIM TOL

DRAW

CHECK

APPROVE

CHANGE

SCALE

UNIT

SIZE

SHEET

PROJ.

FIT

mm

A4

1/1

◆



深圳市连盛精密连接器有限公司
 Shenzhen Liansheng Precision Connector Co., Ltd.

A

F

E

D

C

B

1

2

3

4

5

6

7

8

9

G

F

E

D

C

B

A

1

2

3

4

5

6

7

8

9

G

F

E

D

C

B

A

REV	DATE	MODIFICATION DESCRIPTION	CHANGE
A0	2012.04.18	NEW DRAWING	

OPERATION	DRAW	CHECK	APPROVE
X.X ±0.30			
X.XX ±0.20			
X.XXX ±0.10			
Angle ±3°			
DIM TOL			

SCALE	FIT
UNIT	mm
SIZE	A4
SHEET	1/1
PROJ.	◆

PART NO.	1.27FH 2XNP SMT 带内柱 H=2.1
TITLE:	