

RoHS

SPECIFICATIONS

Rated Current:1.5AMP
 Contact Resistance:20mΩ Max
 Withstand Voltage:500V AC/DC
 Insulation Resistance:1000MΩ Min
 Operation Temperature:—40°c to +105°c

Contact Material:Phosphor Bronze
 Contact Plating:Au Over Ni
 Insulator Material:Polyester(UL94V-0)
 Standard: PA9T
 Max.Processing Temp: 230°C for 30—60 seconds
 (260°C for 10 seconds)

Recommended P.C.B Layout(Top Side)
 (PCB BOARD TOLERANCE±0.05)

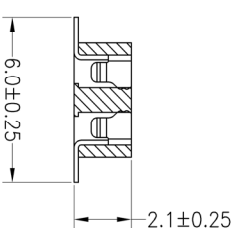
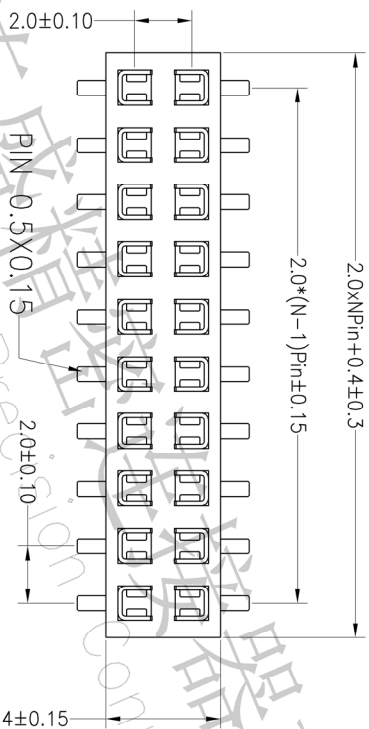
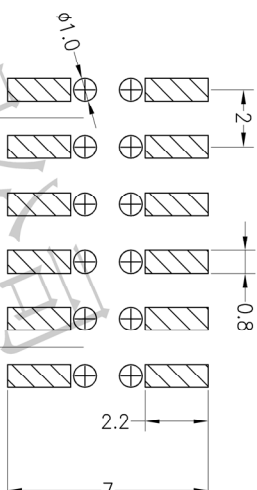

Ordering Information

F	X	A	X	XX	X	X	XX	X	XXXX
产品类型	间距	塑胶高度	封装	单排PIN数	产品形态	塑胶材料	电镀厚度	包装方式	序列号
F-排母	1=1.27 2=2.0 3=2.54 4=3.96 5=5.0 6=6.0 7=5.08 A=1.27/2.54	A=2.0	1=单排 2=双排 3=三排 4=四排	1=0P 2=1A 3=2A 4=3A 5=4A 6=5A 7=6A	1=PS 2=LCP 3=PPS 4=PA6 5=PA6T 9=PA9T	1=0P 2=1A 3=2A 4=3A 5=4A 6=5A 7=6A	00=高模 01=14° 02=20° 03=30° SV=侧插	1=管装 2=卷装 3=散装 4=盒装 5=盘装	

OPERATION		DRAW		SCALE		FIT		PART NO.	
X.X	±0.30	X.XX	±0.20	X.XX	mm	A4	1/1	2.0FH H2.00mm 2XNpin SMT	
X.XXX	±0.10	CHECK		SIZE				TITLE:	
Angle	±3°	APPROVE		SHEET				2.0FH H2.00mm 2XNpin SMT	
DIM	TOL			PROJ.					
1	2	3	4	5	6	7	8	9	

