

RoHS

SPECIFICATIONS

Rated Current:1.5AMP
 Contact Resistance:20mΩ Max
 Withstand Voltage:500V AC/DC
 Insulation Resistance:1000MΩ Min
 Operation Temperature:-40°c to +105°c

Contact Material:Brass
 Contact Plating:Au Over Ni
 Insulator Material:Polyester(UL94V-0)
 Standard: PA6T
 Max.Processing Temp: 230°C for 30-60 seconds
 (260°C for 10 seconds)

Ordering Information

F	X	X	X	XX	X	X	XX	X	XXXX
产品类别	间距	塑胶厚度	排数	每排脚数	产品形态	塑胶材料	电镀厚度	包装方式	存身号
F=排母	27	C=4.0	1=10排	1-10P	1=FB	1=FR	0=平焊	1=管装	
	2x2.54		2=2X排		2=DR	0=10°		2=卷装	
	3x2.54		3=3X排		3=SMT	0=2.0°		3=盘装	
	4x3.96		4=4X排		4=SH	0=3.0°		4=袋装	
	5x1.0				5=FRS			5=盘装	
	6x0.8				6=插孔SMT	SV=拔锡		6=盘装	
	7x5.08				7=插孔90度			7=盘装	
	A=1.27/2.54								

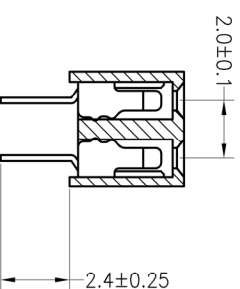
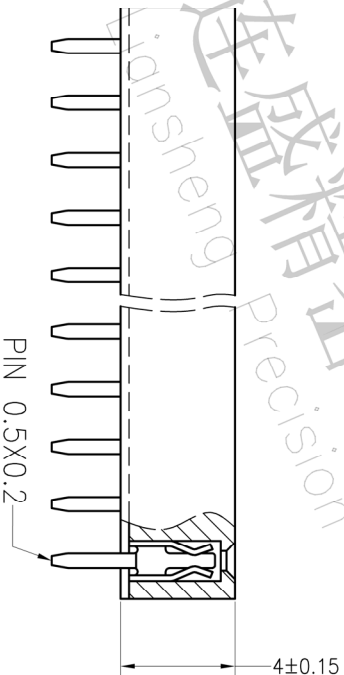
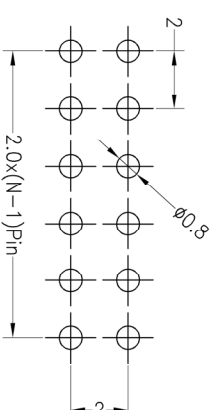
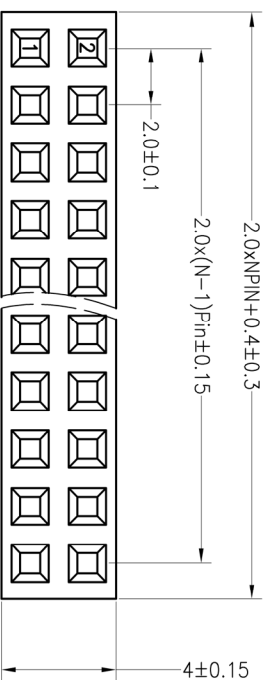

OPERATION		DRAW		SCALE		FIT		PART NO.	
X.X	±0.30			UNIT	mm				
X.XX	±0.20	CHECK		SIZE	A4				
X.XXX	±0.10			SHEET	1/1				
Angle	±3°	APPROVE		PROJ.				TITLE:	
DIM	TOL							2.0FH H4.0 W=4.0 2XNpin 180° PC2.4	

深圳市连盛精密连接器有限公司
 Shenzhen Liansheng Precision Connector Co., Ltd.

Recommended P.C.B Layout(Top Side)
 (PCB BOARD TOLERANCE±0.05)