

ROHS

SPECIFICATIONS

Rated Current:1.5AMP
 Contact Resistance:20mΩ Max
 Withstand Voltage:500V AC/DC
 Insulation Resistance:1000MΩ Min
 Operation Temperature: -40°C to +105°C

Contact Material:Brass
 Contact Plating:Au or Sn Over Ni
 Insulator Material:Polyester(UL94V-0)
 Standard: PA6T
 Max.Processing Temp: 230°C for 30-60 seconds
 (260°C for 10 seconds)

Recommended P.C.B Layout(Top Side)
 (PCB BOARD TOLERANCE±0.05)

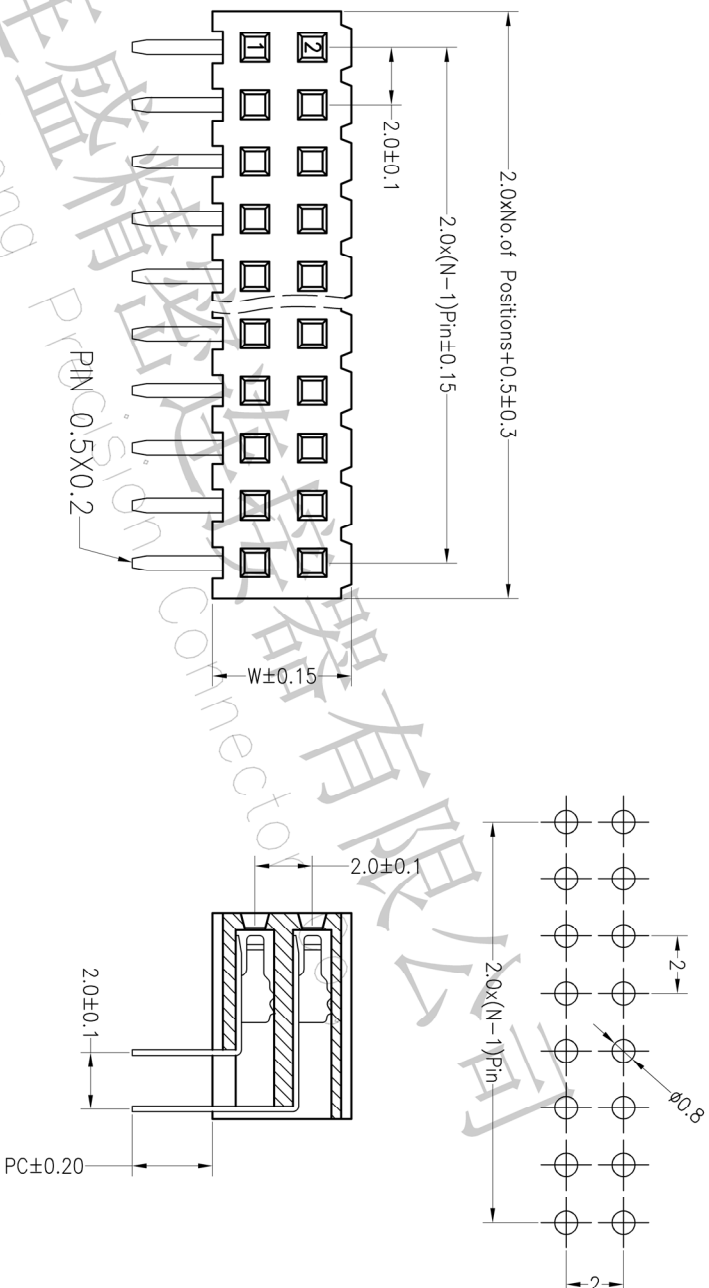

Ordering Information

F	X	K	X	XX	X	XX	X	XXXX
产品型号	插孔间距	插孔直径	插孔深度	插孔长度	插孔直径	插孔长度	插孔直径	插孔长度
1x1.27	2.0	1.0	1.0	1.0	1.0	1.0	1.0	1.0
2x2.5	2.0	1.0	1.0	1.0	1.0	1.0	1.0	1.0
4x3.96	2.0	1.0	1.0	1.0	1.0	1.0	1.0	1.0
6x6.3	2.0	1.0	1.0	1.0	1.0	1.0	1.0	1.0
8x8.6	2.0	1.0	1.0	1.0	1.0	1.0	1.0	1.0
12x12.9	2.0	1.0	1.0	1.0	1.0	1.0	1.0	1.0
16x17.3	2.0	1.0	1.0	1.0	1.0	1.0	1.0	1.0

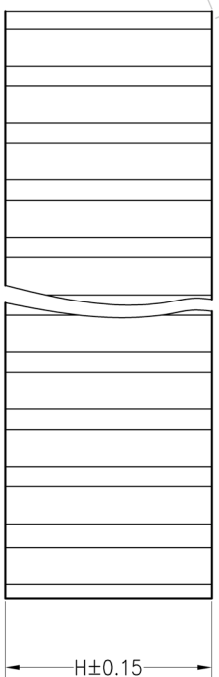

ITEM	PB	PC	PW	H	W
001		2.8		7.2	4.85
002					

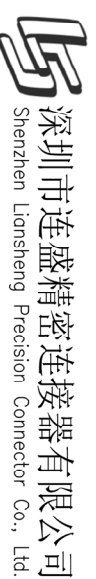

深圳市连盛精密连接器有限公司
 Shenzhen Liansheng Precision Connector Co., Ltd.

REV	DATE	MODIFICATION DESCRIPTION	CHANGE	OPERATION	DRAW	SCALE	FIT	PART NO.	TITLE:
A0	2012.04.18	NEW DRAWING		X.X ±0.30	CHECK	UNIT mm	A4		
1				X.XX ±0.20		SIZE A4	1/1		
				X.XXX ±0.10		SHEET			
				Angle ±3°	APPROVE	PROJ.			
				DIM TOL					2.0FH H7.2mm 2xNpin 90°