

RoHS

SPECIFICATIONS

Rated Current:1.5AMP
 Contact Resistance:20mΩ Max
 Withstand Voltage:500V AC/DC
 Insulation Resistance:1000MΩ Min
 Operation Temperature:-40°c to +105°c

Contact Material:Brass
 Contact Plating:Au Over Ni
 Insulator Material:Polyester(UL94V-0)
 Standard: PA6T
 Max.Processing Temp: 230°C for 30-60 seconds
 (260°C for 5 seconds)

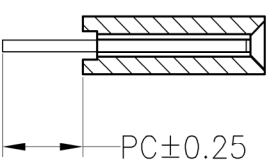
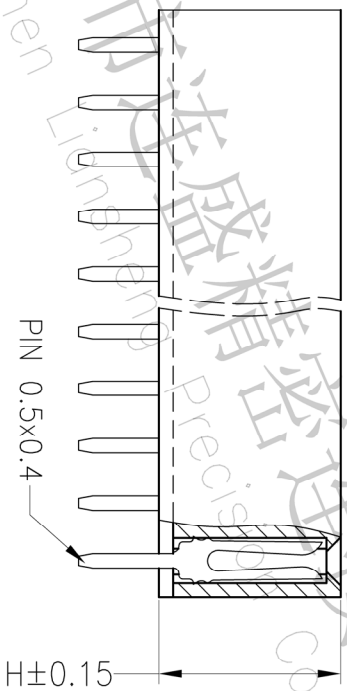
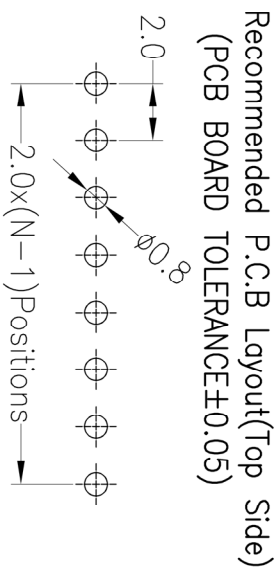
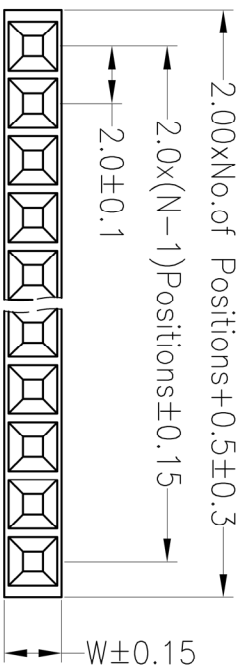

Shenzhen Lionsheng Precision Connector Co., Ltd.

Ordering Information

F	X	X	R	X	X	XX	X	X	XX	X	X	XXXX
产品系列	插针	间距	镀层	材料	绝缘	长度	高度	直径	公差	包装	温度	认证
1-插针	2-2.54	2.54	2-镀金	3-1.0	4-插针	5-1.0	6-1.0	7-1.0	8-1.0	9-1.0	10-1.0	11-1.0
1-插针	2-2.54	2.54	2-镀金	3-1.0	4-插针	5-1.0	6-1.0	7-1.0	8-1.0	9-1.0	10-1.0	11-1.0

ITEM	PB	PC	PW	H	W
001		2.8		6.35	2.00
002		3.0			

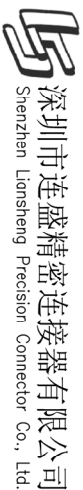

深圳市连盛精密连接器有限公司
 Shenzhen Lionsheng Precision Connector Co., Ltd.

REV	DATE	MODIFICATION DESCRIPTION	CHANGE	OPERATION		DRAW		SCALE		FIT	PART NO.	TITLE:
				X.X	±0.30	CHECK	UNIT	mm	SIZE			
A0	2012.04.18	NEW DRAWING		X.XX	±0.20	CHECK		A4				
1				Angle	±3°	APPROVE						2.0FH H6.35mm 1x4pin 180°