

ROHS

SPECIFICATIONS

Rated Current:1.5AMP
 Contact Resistance:20mΩ Max
 Withstand Voltage:500V AC/DC
 Insulation Resistance:1000MΩ Min
 Operation Temperature:-40°c to +105°c
 Contact Material:Brass
 Contact Plating:Au or Sn Over Ni
 Insulator Material:Polyester(UL94V-0)
 Standard: PA6T
 Max.Processing Temp: 230°C for 30-60 seconds
 (260°C for 10 seconds)

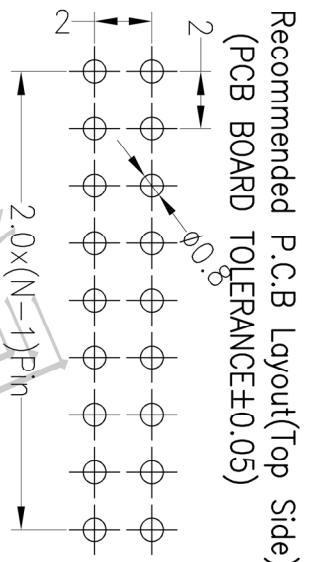
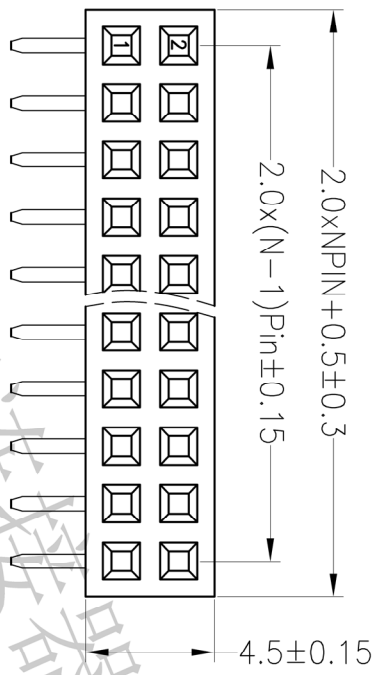

Ordering Information

F	X	D	X	XX	X	X	XX	X	XXXX
产品型号	线径	接触长度	接触	绝缘材料	产品外形	接触材料	电镀厚度	包装形式	序列号
1=1.27	1=0.8	D=4.3	1=0.8	1=PPS	1=0.8	1=PPS	0.05	1=卷装	1=0.8
2=2.0	2=1.0		2=1.0	2=PPS	2=1.0	2=PPS	0.11	2=盘装	2=1.0
4=4.0	4=2.0		4=2.0	4=PPS	4=2.0	4=PPS	0.27	4=盘装	4=2.0
5=1.0	5=0.8		5=0.8	5=PPS	5=0.8	5=PPS	0.35	5=盘装	5=0.8
6=0.8	6=0.8		6=0.8	6=PPS	6=0.8	6=PPS	0.35	6=盘装	6=0.8
A=127±0.54				7=PPS/0.8				7=盘装	

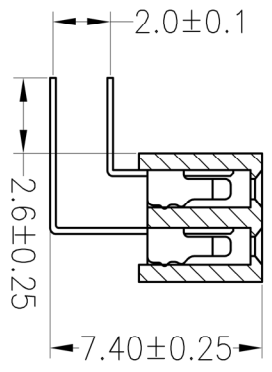
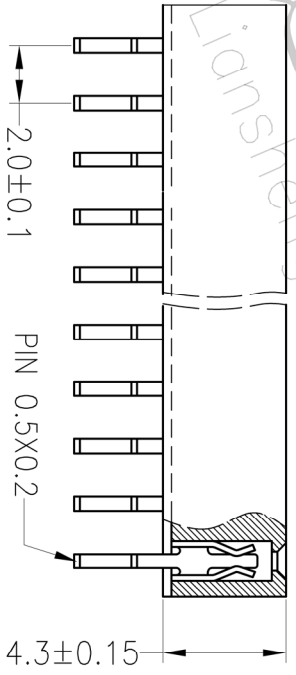

OPERATION		DRAW		SCALE		FIT		PART NO.	
X.X	±0.30			UNIT	mm			SIZE	A4
X.XX	±0.20	CHECK		SHEET		1/1		SHEET	
X.XXX	±0.10			APPROVE				PROJ.	
Angle	±3°							TITLE:	
DIM	TOL							2.00PF H4.3mm 2xNpin 90° W4.50	
REV	DATE	MODIFICATION DESCRIPTION		CHANGE					
A0	2012.07.23	NEW DRAWING							
1									

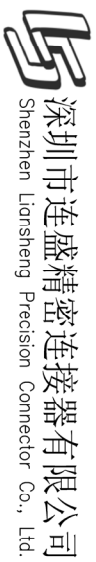

深圳市连盛精密连接器有限公司
 Shenzhen Liansheng Precision Connector Co., Ltd.