

# ROHS

## SPECIFICATIONS

Rated Current:1.5AMP  
 Contact Resistance:20mΩ Max  
 Withstand Voltage:500V AC/DC  
 Insulation Resistance:1000MΩ Min  
 Operation Temperature:-40°C to +105°C

Contact Material:Brass  
 Contact Plating:Au or Sn Over Ni  
 Insulator Material:Polyester(UL94V-0)  
 Standard: PA6T  
 Max.Processing Temp: 230°C for 30-60 seconds  
 (260°C for 10 seconds)

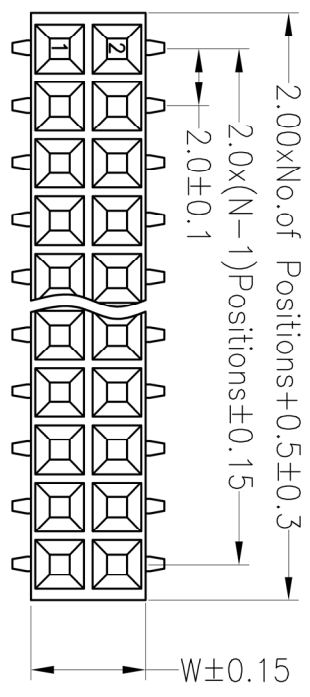

Recommended P.C.B Layout(Top Side)  
 (PCB BOARD TOLERANCE±0.05)

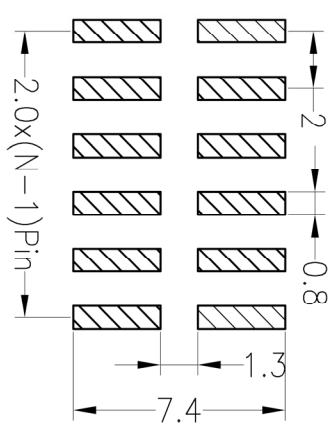

## Ordering Information

F	X	R	X	XX	X	XX	X	XXXX
产品型号	插孔	插孔间距	插孔直径	插孔深度	插孔长度	插孔位置	插孔公差	零件号
F-1113	1x1.27	1x1.27	1-0.40	1-0.80	1-0.80	1-0.80	±0.15	
	1x2.54	1x2.54	1-0.40	1-0.80	1-0.80	1-0.80	±0.15	
	3x2.54	3x2.54	1-0.40	1-0.80	1-0.80	1-0.80	±0.15	
	5x2.54	5x2.54	1-0.40	1-0.80	1-0.80	1-0.80	±0.15	
	6x2.54	6x2.54	1-0.40	1-0.80	1-0.80	1-0.80	±0.15	
	8x2.54	8x2.54	1-0.40	1-0.80	1-0.80	1-0.80	±0.15	
	12x2.54	12x2.54	1-0.40	1-0.80	1-0.80	1-0.80	±0.15	

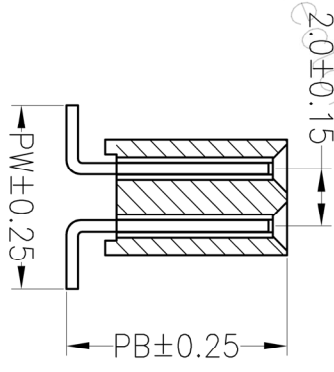
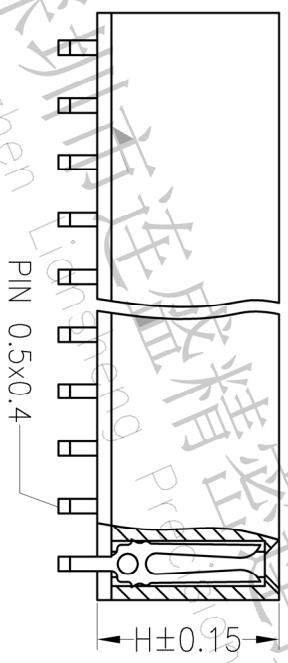

Dimension antitheses list					
ITEM	PB	PC	PW	H	W
001			6.4	6.35	4.00
002					

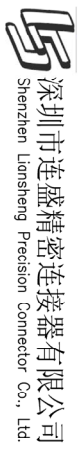

深圳市连盛精密连接器有限公司  
 Shenzhen Lionsheng Precision Connector Co., Ltd.

REV	DATE	MODIFICATION DESCRIPTION	CHANGE	OPERATION		DRAW	SCALE		FIT	PART NO.	TITLE:
				X.X	±0.30		UNIT	mm			
A0	2012.04.18	NEW DRAWING		X.XX	±0.20	CHECK	SIZE	A4	1/1		2.0FH H6.35mm 2xNpin SMT平面
				X.XXX	±0.10	APPROVE	SHEET				
				Angle	±3°		PROJ.				
				DIM	TOL						