

RoHS

SPECIFICATIONS

Rated Current:1.5AMP
 Contact Resistance:20mΩ Max
 Withstand Voltage:500V AC/DC
 Insulation Resistance:1000MΩ Min
 Operation Temperature:-40°c to +105°c

Contact Material:Brass
 Contact Plating:Au or Sn Over Ni
 Insulator Material:Polyester(UL94V-0)
 Standard: PA6T
 Max.Processing Temp: 230°C for 30-60 seconds
 (260°C for 5 seconds)

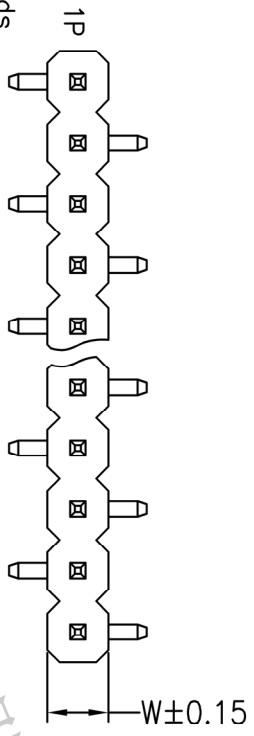
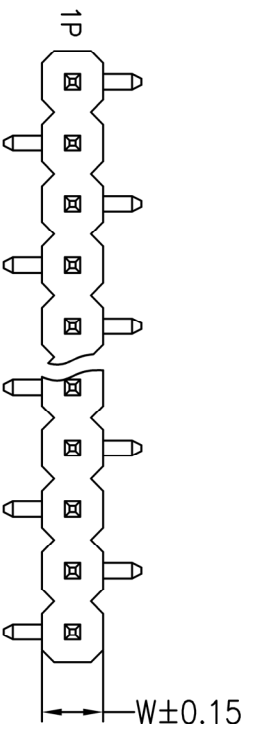

Recommended P.C.B Layout(Top Side)
 (PCB BOARD TOLERANCE±0.05)

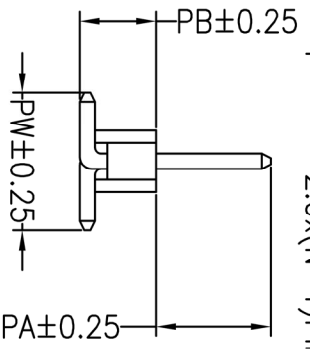
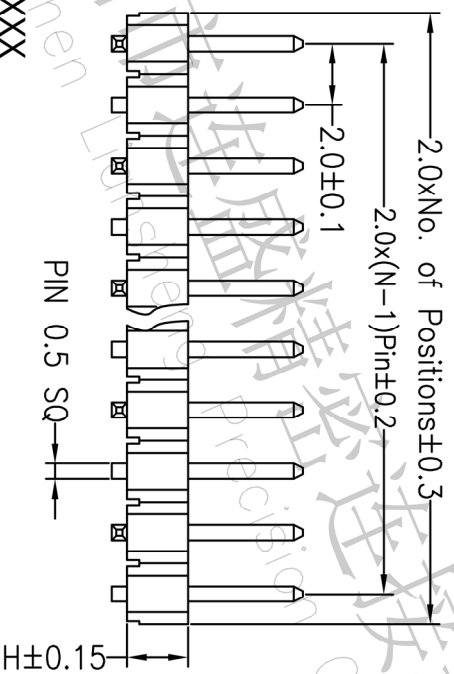
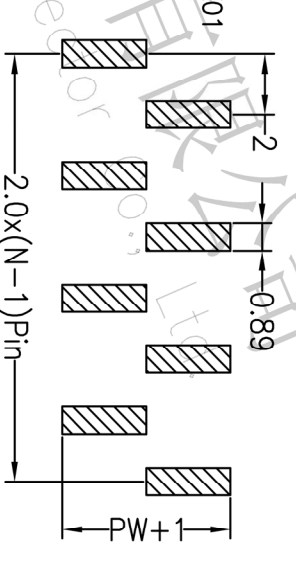
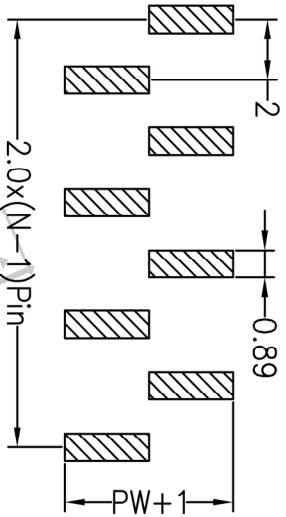

Ordering Information

P X X X X XX X X XX X XXX

产品类别: 1=1.27, 2=2.0, 3=2.54, 4=3.96, 5=1.0
 间距: A=1.0, B=1.5, C=2.0, D=2.5
 引脚数: 1=单排, 2=双排
 单排PIN数: 1-40P
 产品形态: 1=DP, 2=RA, 3=SMT, 4=SI, 5=线端脚
 塑胶材料: 1=PA, 2=LCP, 3=PPS, 4=PA6, 5=PA6T, 9=PA9T
 电镀厚度: 00=常规, 01=1μ, 02=2μ, 03=3μ
 包装方式: 1=管装, 2=卷装, 3=盘装, 4=袋装, 5=盘装
 序列号: XXXX

Dimension antitheses list						
ITEM	PA	PB	PW	L	H	W
001	3.80	2.50	4.50	8.00	1.5/2.0	2.0
Alternate						

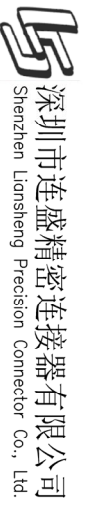

深圳市连盛精密连接器有限公司
 Shenzhen Liansheng Precision Connector Co., Ltd.

OPERATION		DRAW		SCALE		FIT		PART NO.	
X.X	±0.30	X.X	±0.30	UNIT	mm	SIZE	A4	SHEET	1/1
X.XX	±0.20	CHECK	CHECK	ANGLE	±0.10	APPROVE	APPROVE	TITLE:	2.0PH 1XNP SMT
X.XXX	±0.10			DIM	TOL				
A0	2012.10.05	NEW DRAWING		CHANGE		DIM		TOL	
REV	DATE	MODIFICATION DESCRIPTION		CHANGE		DIM		TOL	
1									