

RoHS

SPECIFICATIONS

Rated Current:3.0AMP
 Contact Resistance:20mΩ Max
 Withstand Voltage:1000V AC/DC
 Insulation Resistance:1000MΩ Min
 Operation Temperature:−40°c to +105°c

Contact Material:Brass
 Contact Plating:Au Over Ni

Insulator Material:Polyester(Ul94V-0)

Standard: PA6T

Max.Processing Temp: 230°C for 30–60 seconds
 (260°C for 10 seconds)

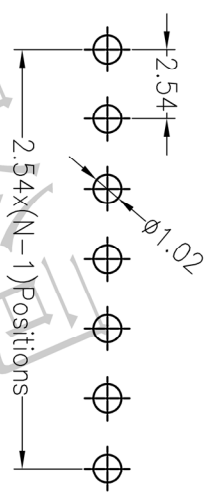
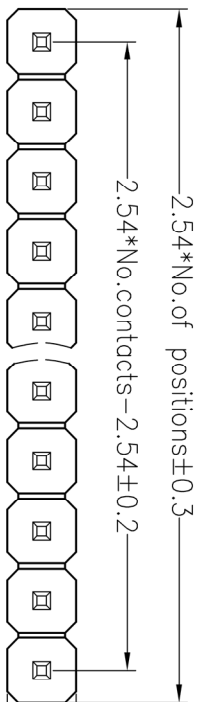

Recommended P.C.B Layout(Top Side)
 (PCB BOARD TOLERANCE±0.05)

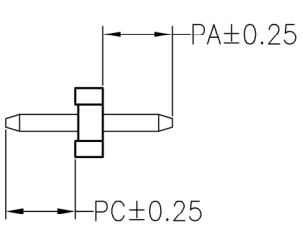
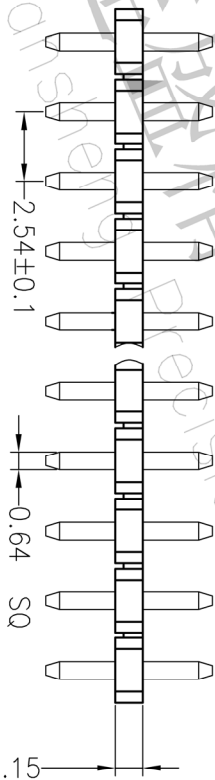

1.00±0.15

Ordering Information

P X X X X XX X X XX X XXXX

产品类型 P=排针
 方向 1=1.27
 2=2.0
 3=2.54
 4=3.86
 5=1.27*2.54
 塑胶高度 A=1.0
 B=1.5
 C=2.0
 D=2.5
 排数 1=单排
 2=双排
 3=三排
 4=四排
 单排PIN数 1~40P
 产品形态 1=EP
 2=RA
 3=SN
 4=SH
 5=弯引脚
 塑胶材料 1=PET
 2=CP
 3=PPS
 4=PA6
 5=PA6T
 9=PA9T
 电镀厚度 00=常规
 01=1u"
 02=2u"
 03=3u"
 包装方式 1=管装
 2=卷装
 3=盘装
 4=袋装
 5=盘装
 序列号

Dimension antitheses list				
ITEM	PC	PA	L	
Standard	3.00	3.00	7.00	
Alternate				

深圳市连盛精密连接器有限公司
 Shenzhen Liansheng Precision Connector Co., Ltd.

OPERATION		DRAW		SCALE		FIT		PART NO.	
X.X	±0.30	X.X	±0.30	UNIT	mm	mm	A4	SIZE	A4
X.XX	±0.20	CHECK		SHEET	1/1	SHEET		1/1	TITLE:
X.XXX	±0.10	Angle	±3°	APPROVE	PROJ.	TITLE:		2.54PH H=1.0mm 1XNP DIP PA3.0	FC3.0 L=7.0 AU0.8U PA6T
REV	DATE	MODIFICATION DESCRIPTION		CHANGE	DIM	TOL	8	9	
A0	2012.07.02	NEW DRAWING							
1									