

# ROHS

## SPECIFICATIONS

Rated Current:5.0AMP  
 Contact Resistance:20mΩ Max  
 Withstand Voltage:500V AC/DC  
 Insulation Resistance:1000MΩ Min  
 Operation Temperature: -40°C to +105°C

Contact Material:Brass  
 Contact Plating:Au or Sn Over Ni  
 Insulator Material:Polyester(UL94V-0)  
 Standard: LCP  
 Max.Processing Temp: 230°C for 30-60 seconds  
 (260°C for 5 seconds)

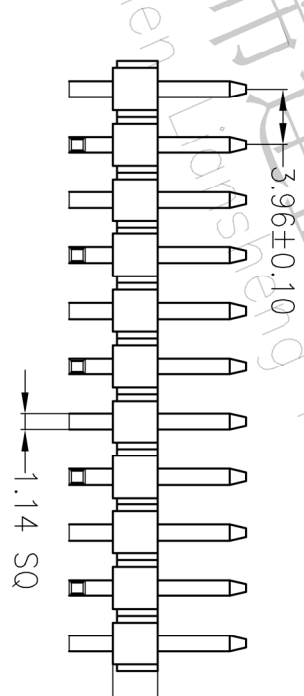
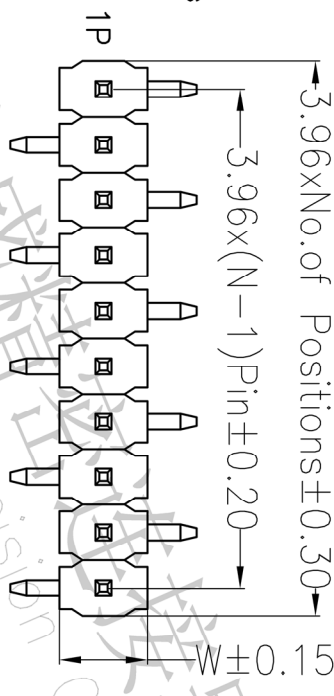
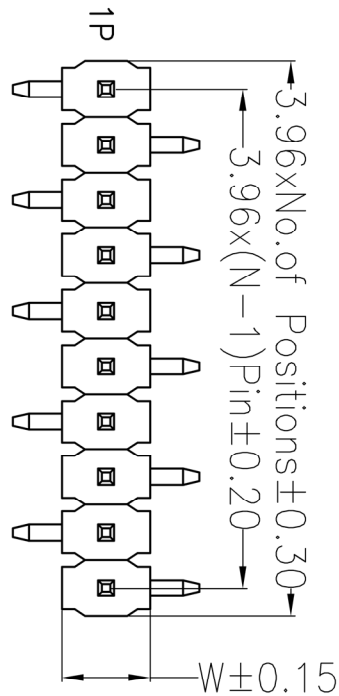

Recommended P.C.B Layout(Top Side)  
 (PCB BOARD TOLERANCE±0.05)

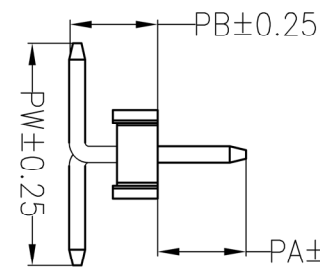
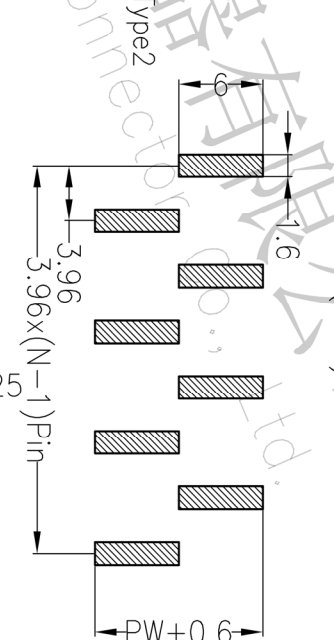
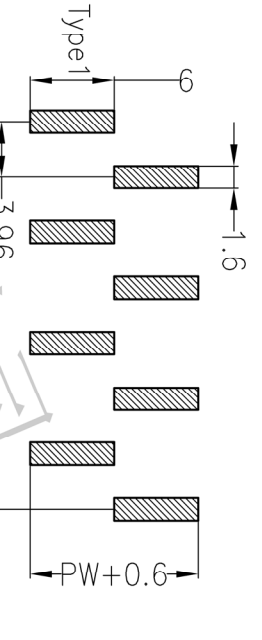

## Ordering Information

P	X	X	X	XX	X	X	XX	X	XXXX
产品数量	间距	额定高度	排数	单排Pin数	产品规格	绝缘材料	电绝缘度	包装方式	序列号
1~12	A=1.0	B=1.27	1~4排	1~40P	1-PPH	0.1mm	1-管装	1-管装	
3~254	B=2.0	C=2.54	3~24排	2~40P	2-PPS	0.2mm	2-管装	2-管装	
4~3.96	D=2.5	E=3.18	4~10排	3~50P	3-SMT	0.3mm	3-管装	3-管装	
A=1.27~1.54				5~50P	4-PPAG	0.3mm	4-管装	4-管装	
				5~50P	5-PPAGT	0.3mm	5-管装	5-管装	
				9-PPAGT	9-PPAGT	0.3mm	9-管装	9-管装	

ITEM	PA	PB	PW	L1	L2	L3	H	W
001	8.00	5.20	10.0				3.2	6.3

Dimension orthtesses list  
 Alternate

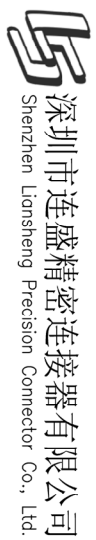

深圳市连盛精密连接器有限公司  
 Shenzhen Liancheng Precision Connector Co., Ltd.

OPERATION		DRAW		SCALE		FIT		PART NO.	
X.X	±0.30	X.X	±0.30	UNIT	mm	A4	1/1	3.96PH 1XNP SMT	
X.XX	±0.20	CHECK		SIZE	A4	SHEET		TITLE:	
X.XXX	±0.10	APPROVE		PROJ.		TITLE:		3.96PH 1XNP SMT	
Angle	±3°								
DIM	TOL								

REV	DATE	MODIFICATION DESCRIPTION	CHANGE	DIM	TOL	PROJ.	TITLE:
A0	2012.04.11	NEW DRAWING					3.96PH 1XNP SMT
1							