

1 RoHS

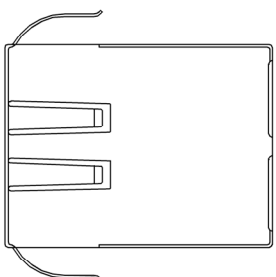

TOP VIEW

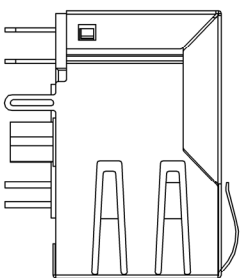

LEFT SIDE VIEW

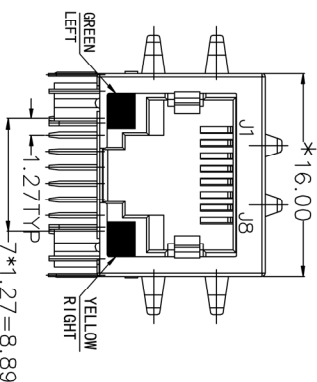

FRONT VIEW

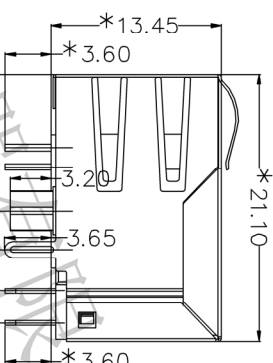

RIGHT SIDE VIEW

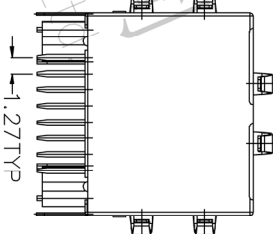

BACK VIEW

**MATERIAL:**  
 HOUSING : PBT,UL94V-0,BLACK.  
 TERMINALS BRACKET: PBT,UL94V-0,BLACK.  
 SHIELD: C2680,T=0.20MM,NICKEL PLATING ON ALL AREA.  
 TERMINAL: PHOSPHOR BRONZE C5210,T=0.35MM,  
 6U" GOLD PLATING ON CONTACT AREA.

**MECHANICAL:**  
 DURABILITY : 750 CYCLES MIN.  
 MATING FORCE : 23N MAX.  
 OPERATING TEMPERATURE: -40°C~+85°C.  
 STORAGE TEMPERATURE: -40°C~+85°C.  
 ALL CRITICAL DIMENSIONS WITH "\*"

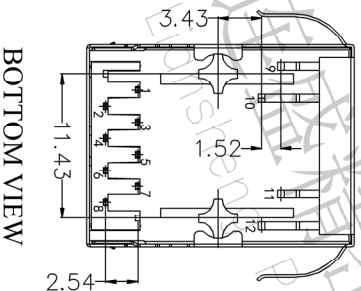

BOTTOM VIEW

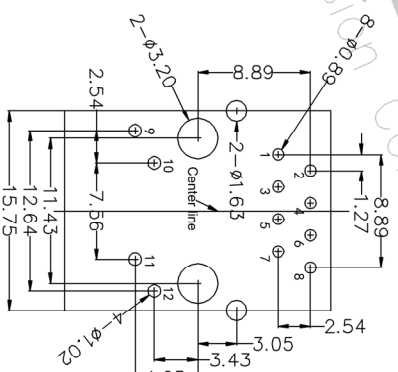

RECOMMENDED PCB LAYOUT  
 VIEWED FROM COMPONENT SIDE

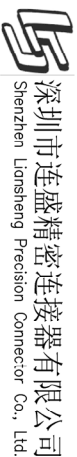

深圳市连盛精密连接器有限公司  
 Shenzhen Liansheng Precision Connector Co., Ltd.

		OPERATION		DRAW		SCALE		FIT	
		X.X	±0.30	DRAW		UNIT	mm		
		X.XX	±0.20	CHECK		SIZE	A4		
		X.XXX	±0.10	APPROVE		SHEET	1/1		
		Angle	±3°	PRD.		TITLE:			
		DIM	TOL	PART NO.		TAB-DOWN 1X1 100BASE			
A0	2012.03.28	NEW DRAWING							
REV	DATE	MODIFICATION DESCRIPTION		CHANGE					
1									

RoHS

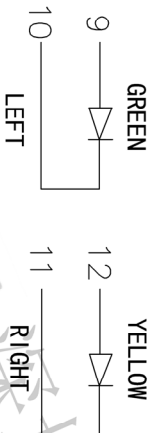
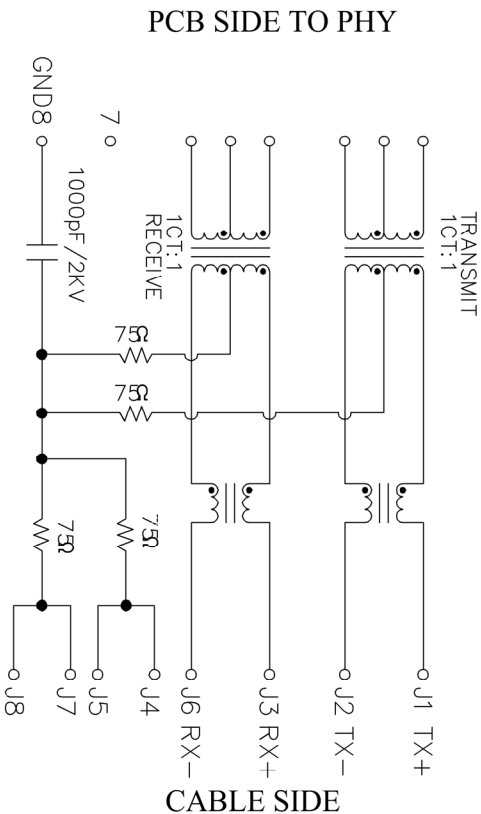

**Electrical:**

- Turn Ratio: 1~2: J1~J2=1CT:1CT(±2%), 3~6: J3~J6=1CT:1CT(±2%).
- OCL: 350uH Min at 100KHz 100mV 8mA DC.
- Insertion Loss: -1.0 dB Max 1 ~100MHz.
- Return loss: -18dB Min 1~30MHz;  
-14dB Min 30 ~60MHz;  
-10dB Min 60 ~100MHz.
- Cross talk: -40dB Min 1~30MHz;  
-35dB Min 30 ~60MHz;  
-30dB Min 60 ~100MHz;
- CMR: -30dB Min 1 ~100MHz;
- Hi-Pof: 1500V AC & 2250V DC  
6S 1mA PRI TO SEC

**LED Specification**

Standard LED Color	LED Wavelength	Forward(A) Power(W)
Green	568nm20mA	1.85-2.45V
Yellow	585nm	20mA 1.7-2.2V



深圳市连盛精密连接器有限公司  
Shenzhen LianSheng Precision Connector Co., Ltd.

OPERATION		DRAW		SCALE		FIT		PART NO.	
X.X		±0.30		UNIT		mm		A4	
X.XX		±0.20		SIZE		A4		SHEET	
X.XXX		±0.10		CHECK		1/1		TITLE:	
Angle		±3°		APPROVE		PRD.		TAB-DOWN 1X1 100BASE	
DIM		TOL		APPROVE		PRD.		TAB-DOWN 1X1 100BASE	
CHANGE		CHANGE		APPROVE		PRD.		TAB-DOWN 1X1 100BASE	
MODIFICATION DESCRIPTION		CHANGE		APPROVE		PRD.		TAB-DOWN 1X1 100BASE	
DATE		CHANGE		APPROVE		PRD.		TAB-DOWN 1X1 100BASE	
2012.03.28		CHANGE		APPROVE		PRD.		TAB-DOWN 1X1 100BASE	
NEW DRAWING		CHANGE		APPROVE		PRD.		TAB-DOWN 1X1 100BASE	
REV		CHANGE		APPROVE		PRD.		TAB-DOWN 1X1 100BASE	
1		CHANGE		APPROVE		PRD.		TAB-DOWN 1X1 100BASE	

1  
2  
3  
4  
5  
6  
7  
8  
9

RoHS

PROFILE OF WAVE SOLDER

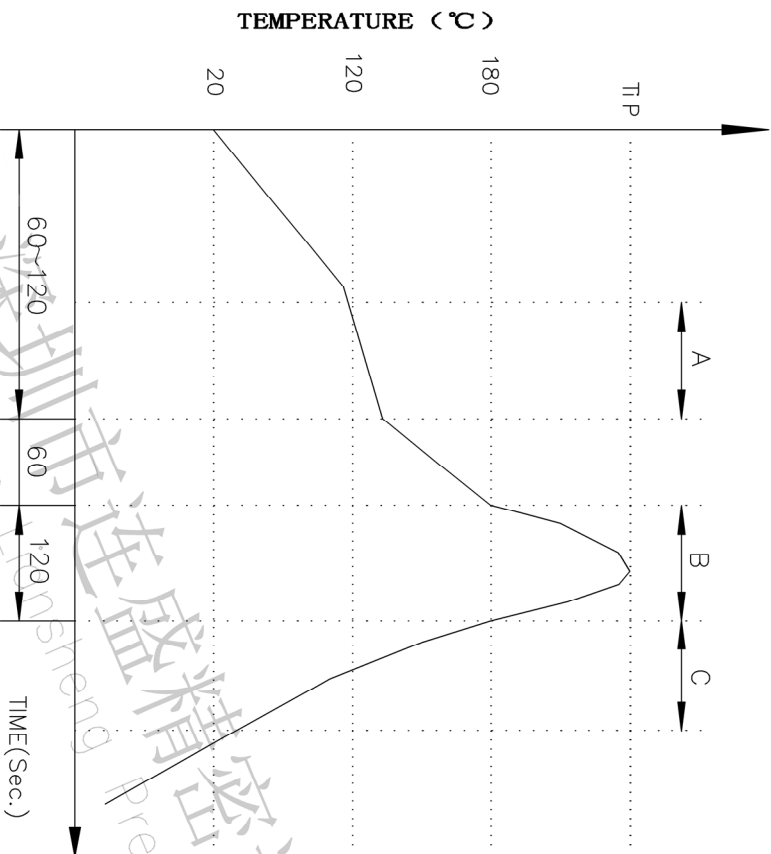

- A. Preheating B. Soldering C. Gradual Cooling  
 Tip temperature: 260±5°C.  
 Tip temperature time: 5Sec Max.  
 Tip melting point of Sn96.5/Ag3/Cu0.5: 217°C.

Remarks: after wave soldering, the plastic positioning columns of the product which under the PCB will be slightly melted, but it won't affect its function.

OPERATION		DRAW		SCALE		FIT		PART NO.	
X.X		±0.30		UNIT		mm		Shenzhen 市连盛精密连接器有限公司 Shenzhen Liansheng Precision Connector Co., Ltd.	
X.XX		±0.20		SIZE		A4		TITLE:	
X.XXX		±0.10		SHEET		1/1		TAB-DOWN 1X1 100BASE	
Angle		±3°		PROJ.		☐			
DIM		TOL		APPROVE					
CHANGE									
MODIFICATION DESCRIPTION		CHANGE							
DATE									
REV									
A0		NEW DRAWING							
2012.03.28									
1		2		3		4		5	
1		2		3		4		5	