

RoHS

MATERIAL:
 HOUSING: LCP, UL94V-0, BLACK.
 TERMINAL: PHOSPHOR BRONZE T=0.35MM, G/F^{III} GOLD PLATING.
 SHIELD: C2680, T=0.20MM, 20 MIN NICKEL PLATING
 ON ALL AREA.

MACHANICAL:
 DURABILITY: 750 CYCLES MIN, 12.5MM/MINUTE.
 INSERTION FORCE: 2.2KG.F MAX.
 RETENTION STRENGTH: 7.7KG.F BETWEEN JACK AND PLUG.
 OPERATING TEMPERATURE: -40 ~ +85
 STORAGE TEMPERATURE: -40°C~+85°C.
 ALL CRITICAL DIMENSIONS WITH "mm"

ELECTRICAL:
 VOLTAGE: 125 VOLTS AC.
 CURRENT RATING: 1.5AMP
 DIELECTRIC STRENGTH: 1000 VAC RMS 50HZ OR 60HZ, 1MIN.
 INSULATION RESISTANCE: 500 MEGA OHMS MIN. INITIAL
 AFTER 500V DC FOR 1 MINUTE.
 CONTACT RESISTANCE: SINGLE TERMINAL 30 MILLIOHMS MAX.
 INITIAL 50 MILLIOHMS MAX. AFTER
 DURABILITY TEST.

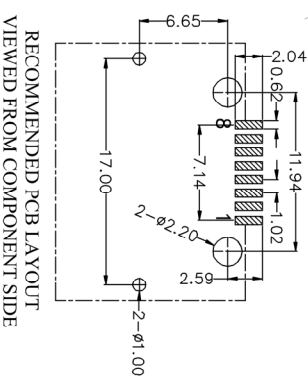
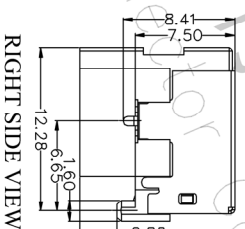
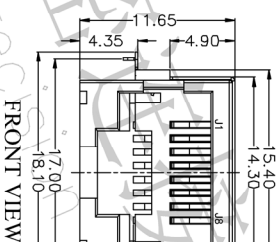
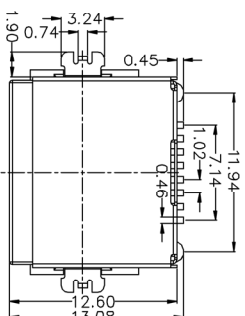
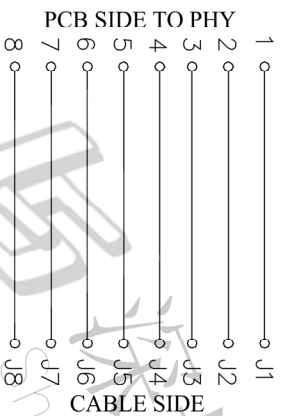

| OPERATION | | DRAW | | SCALE | FIT | PART NO. | TITLE: |
|------------|--------------------------|---------|-------|-------|-----|--------------|--------|
| X.X | ±0.30 | X.XX | ±0.20 | UNIT | mm | | |
| X.XXX | ±0.10 | CHECK | | SIZE | A4 | RJ45 SMT 沉板式 | REV |
| Angle | ±3° | APPROVE | | SHEET | 1/1 | | |
| DIM | TOL | CHANGE | | PROD. | | | |
| DATE | MODIFICATION DESCRIPTION | 3 | 4 | 5 | 6 | 7 | 8 |
| 1 | 2 | 3 | 4 | 5 | 6 | 7 | 8 |
| A0 | NEW DRAWING | | | | | | |
| 2012.03.28 | | | | | | | |