

# RoHS

**MATERIALS**  
 Housing: Plastic Thermoplastic, PA6T, UL94V-0, Black  
 Contact Material: Copper Alloy Gold Selective Plated  
 Front Shell: Steel, Nickel Plated Over Copper  
 RoHS Compliant

**ELECTRICAL CHARACTERISTICS**  
 Rated Current: 1.0AMP  
 Withstand Voltage: 500V AC/DC  
 Insulation Resistance: 500MΩ Min  
 Contact Resistance: 35mΩ Max  
 Operation Temperature: -55°C to +105°C

**材质**  
 胶芯: 塑胶 PA6T UL94V-0, 黑色  
 端子: 铜合金, 镀半金锡  
 前壳: 钢材, 镀锌

**规格**  
 额定电流: 1安培  
 最大耐电压: 交流500伏特  
 绝缘电阻: 最小值大于500 百万欧姆  
 接触电阻: 最大值小于35 千分之一欧姆  
 工作温度: -55°C到+105°C

## Ordering Information

6300 M 225 S X X X X 001

M=Male  
 No of Pins Per Row 2X25P  
 Connector Type S=Straight R=Right Angle Z=插座 W=载线脚  
 Insulator Material Option A=BK-PBT B=BK-PA6T C=BK-PA6T D=BK-LCP S=Special  
 Packing A=PE Bag B=BOX C=Tube D=Tube+Cap E=Reel+Cap F=Reel+Mylar  
 Contact Plating G1:1.1μ" Gold G2:1.5μ" Gold G3:2.0μ" Gold G4:3.0μ" Gold G5:5.0μ" Gold SK:Tin

P.C.B Layout

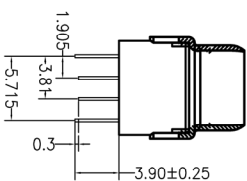
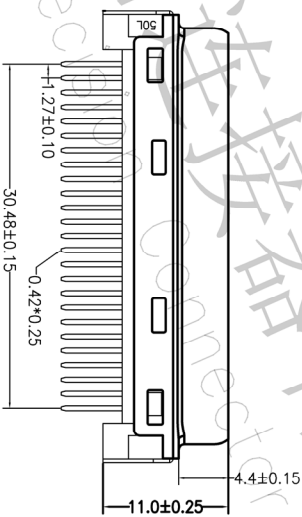
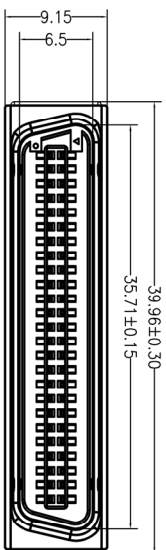
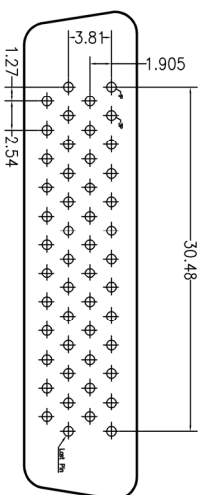

A		B		C		D		E		F		G	
REV	DATE	MODIFICATION DESCRIPTION	CHANGE	OPERATION	DRAW	SCALE	FIT	PART NO.	TITLE:	信号连接器公座	DIP PC3.9	带卡点	
A0	2012.03.28	NEW DRAWING		X.XX ±0.30 X.XX ±0.15 X.XXX ±0.10 Angle ±3° DIM TOL	CHECK APPROVE	UNIT mm SIZE A4 SHEET 1/1 PROJ.							
1	2	3	4	5	6	7	8	9					

**深圳市连盛精密连接器有限公司**  
 Shenzhen Liansheng Precision Connector Co., Ltd.